

STYLI FOR FARO ARM

M6 Thread Styli	Order No.	Ball	Shaft	dk mm	d1 mm	L mm	ML mm
Styli	3.0-48-6 NTBR	Ruby	TC	3.0	2.0	48.0	10.0
	3.0-48-6 NTBZ	Zircon	TC	3.0	2.0	48.0	10.0
	3.0-48-6 NTBH	Carbide	TC	3.0	2.0	48.0	10.0
	6.0-48-6 NTBR	Ruby	TC	6.0	3.0	48.0	10.0
	6.0-48-6 NTBZ	Zircon	TC	6.0	3.0	48.0	10.0
	6.0-48-6 NTBH	Carbide	TC	6.0	3.0	48.0	10.0

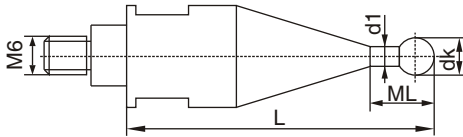

Zircon = Zirconia Oxide

TC = Tungsten Carbide

M6 Thread Adaptor	Order No.	Adaptor	Material	Thread "G"	L mm
Adaptor	6-2 NAF	M6/M2	Steel	M2	38.0
	6-3 NAF	M6/M3	Steel	M3	38.0
	6-4 NAF	M6/M4	Steel	M4	38.0
	6-5 NAF	M6/M5	Steel	M5	38.0

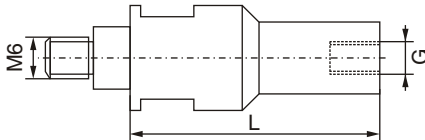

For use with **M2, M3, M4, M5** thread styli

1/4 -20 UNF Thread Styli	Order No.	Ball	Shaft	dk mm	d1 mm	L mm	ML mm
Styli	3-60-1/4 -20 NTBR	Ruby	TC	3.0	2.0	60.0	10.0
	3-60-1/4 -20 NTBZ	Zircon	TC	3.0	2.0	60.0	10.0
	3-60-1/4 -20 NTBH	Carbide	TC	3.0	2.0	60.0	10.0
	6-60-1/4 -20 NTBR	Ruby	TC	6.0	3.0	60.0	10.0
	6-60-1/4 -20 NTBZ	Zircon	TC	6.0	3.0	60.0	10.0
	6-60-1/4 -20 NTBH	Carbide	TC	6.0	3.0	60.0	10.0

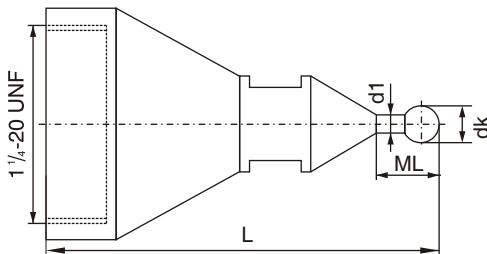

Zircon = Zirconia Oxide

TC = Tungsten Carbide

1/4 -20 UNF Thread Adaptor	Order No.	Adaptor	Material	Thread "G"	L mm
Adaptor	1/4 -20-2 NAF	1/4 -20 UNF /M2	Steel	M2	41.0
	1/4 -20-3 NAF	1/4 -20 UNF /M3	Steel	M3	41.0
	1/4 -20-4 NAF	1/4 -20 UNF /M4	Steel	M4	41.0
	1/4 -20-5 NAF	1/4 -20 UNF /M5	Steel	M5	41.0
	1/4 -20-6 NAF	1/4 -20 UNF /M6	Steel	M6	41.0

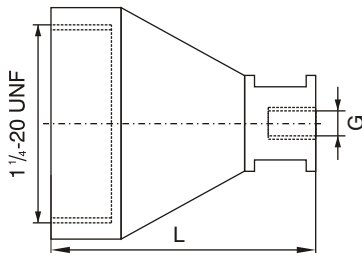

For use with **M2, M3, M4, M5** thread styli