

M1.4 FOR TEST INDICATORS

M1.4 thread styli	Order No.	Shaft	Ball	wt	dk mm	d1 mm	ML mm
Styli for test indicators (Type A)	0.2-12.5-1.4 NTA	TC	Ruby	0.3g	0.2	0.15	1.5
	0.25-12.5-1.4 NTA	TC	Ruby	0.3g	0.25	0.2	2.5
	0.3-12.5-1.4 NTA	TC	Ruby	0.3g	0.3	0.2	2.5
	0.4-12.5-1.4 NTA	TC	Ruby	0.3g	0.4	0.3	2.5
	0.5-12.5-1.4 NTA	TC	Ruby	0.3g	0.5	0.3	2.5
	0.6-12.5-1.4 NTA	TC	Ruby	0.3g	0.6	0.4	4.5
	0.7-12.5-1.4 NTA	TC	Ruby	0.3g	0.7	0.4	4.5
	0.8-12.5-1.4 NTA	TC	Ruby	0.3g	0.8	0.6	4.5
	0.9-12.5-1.4 NTA	TC	Ruby	0.3g	0.9	0.6	4.5
	1.0-12.5-1.4 NTA	TC	Ruby	0.3g	1.0	0.8	4.5

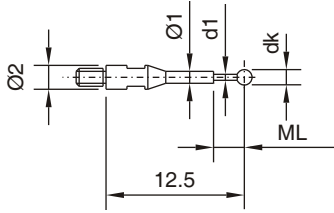
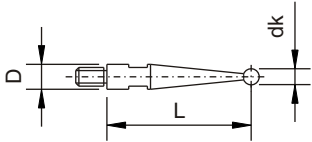

Styli for test indicators (Type C)	Order No.	Shaft	Ball	wt	D mm	dk mm	L mm
	1.0-12.5-1.4 NTC	Steel	Ruby	0.3g	2.0	1.0	12.5
	2.0-12.5-1.4 NTC	Steel	Ruby	0.3g	2.0	2.0	12.5
	3.0-12.5-1.4 NTC	Steel	Ruby	0.4g	2.0	3.0	12.5
	1.0-36.5-1.4 NTC	Steel	Ruby	0.8g	3.0	1.0	36.5
	2.0-36.5-1.4 NTC	Steel	Ruby	0.8g	3.0	2.0	36.5
	3.0-36.5-1.4 NTC	Steel	Ruby	0.9g	3.0	3.0	36.5

TC= Tungsten Carbide.

This new ruby tipped stylus for indicators will outlive a traditional stylus many times over.

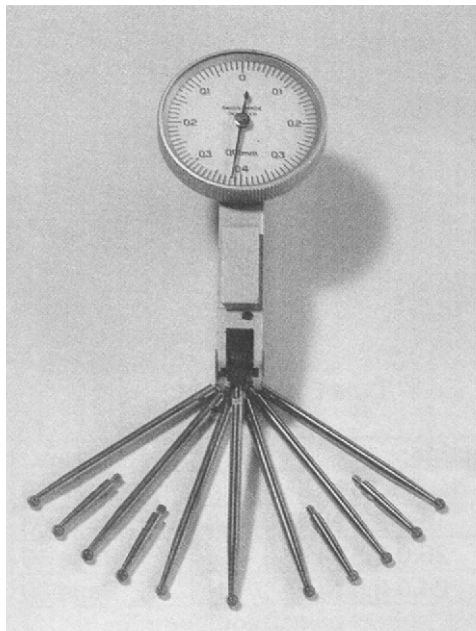

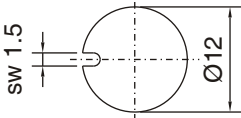
Spanner	Order No.	Description
	1.5 NWGA	1.5mm for M1.4 thread styli

