

M3 (Ø 5 mm)

M3 Thread Styli (Body Ø5mm)

Styli (Type A)

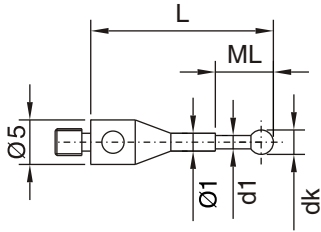

Order No.	Shaft	Ball	wt	dk mm	d1 mm	L mm	ML mm
0.25-11-5 NTA	TC	Ruby	0.8g	0.25	0.2	11.0	2.5
0.25-25-5 NTA	TC	Ruby	1.0g	0.25	0.2	25.0	4.0
0.3-13-5 NTA	TC	Ruby	0.9g	0.3	0.2	13.0	2.5
0.3-15-5 NTA	TC	Ruby	0.9g	0.3	0.2	15.0	2.5
0.3-18-5 NTA	TC	Ruby	1.0g	0.3	0.2	18.0	2.5
0.3-20-5 NTA	TC	Ruby	1.0g	0.3	0.2	20.0	2.5
0.4-13-5 NTA	TC	Ruby	0.9g	0.4	0.3	13.0	2.5
0.4-15-5 NTA	TC	Ruby	0.9g	0.4	0.3	15.0	2.5
0.4-20-5 NTA	TC	Ruby	1.0g	0.4	0.3	20.0	2.5
0.5-13-5 NTA	TC	Ruby	0.9g	0.5	0.3	13.0	2.5
0.5-15-5 NTA	TC	Ruby	0.9g	0.5	0.3	15.0	2.5
0.5-18-5 NTA	TC	Ruby	1.0g	0.5	0.3	18.0	2.5
0.5-20-5 NTA	TC	Ruby	1.0g	0.5	0.3	20.0	2.5
0.5-24-5 NTA	TC	Ruby	1.0g	0.5	0.3	24.0	2.5
0.6-14-5 NTA	TC	Ruby	0.9g	0.6	0.4	14.0	4.5
0.6-17-5 NTA	TC	Ruby	1.0g	0.6	0.4	17.0	4.5
0.6-20-5 NTA	TC	Ruby	1.0g	0.6	0.4	20.0	4.5
0.6-24-5 NTA	TC	Ruby	1.0g	0.6	0.4	24.0	4.5
0.8-17-5 NTA	TC	Ruby	1.0g	0.8	0.6	17.0	5.0
0.8-20-5 NTA	TC	Ruby	1.0g	0.8	0.6	20.0	5.0
0.8-25-5 NTA	TC	Ruby	1.0g	0.8	0.6	25.0	5.0
0.8-34-5 NTA	TC	Ruby	1.1g	0.8	0.6	34.0	4.0
0.8-35-5 NTA	TC	Ruby	1.1g	0.8	0.6	35.0	5.0
1.0-20-5 NTA	TC	Ruby	1.0g	1.0	0.8	20.0	5.0
1.0-25-5 NTA	TC	Ruby	1.0g	1.0	0.8	25.0	5.0
1.0-30-5 NTA	TC	Ruby	1.1g	1.0	0.8	30.0	5.0
1.0-35-5 NTA	TC	Ruby	1.1g	1.0	0.8	35.0	5.0
1.0-40-5 NTA	TC	Ruby	1.2g	1.0	0.8	40.0	5.0

Styli (Type B)

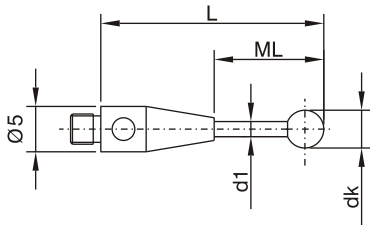

Order No.	Shaft	Ball	wt	dk mm	d1 mm	L mm	ML mm
0.8-14-5 NTB	TC	Ruby	1.0g	0.8	0.6	14.0	5.0
1.0-14-5 NTB	TC	Ruby	1.0g	1.0	0.8	14.0	5.0
1.0-17-5 NTB	TC	Ruby	1.0g	1.0	0.8	17.0	8.0
1.0-20-5 NTB	TC	Ruby	1.0g	1.0	0.8	20.0	11.0
1.35-24-5 NTB	TC	Ruby	1.1g	1.35	1.0	24.0	15.0
1.5-14-5 NTB	TC	Ruby	1.0g	1.5	1.0	14.0	5.0
1.5-17-5 NTB	TC	Ruby	1.0g	1.5	1.0	17.0	8.0
1.5-20-5 NTB	TC	Ruby	1.0g	1.5	1.0	20.0	11.0
1.5-25-5 NTB	TC	Ruby	1.1g	1.5	1.0	25.0	16.0
1.5-30-5 NTB	TC	Ruby	1.1g	1.5	1.0	30.0	21.0
1.5-35-5 NTB	TC	Ruby	1.2g	1.5	1.0	35.0	26.0
1.5-40-5 NTB	TC	Ruby	1.2g	1.5	1.0	40.0	31.0
2.0-14-5 NTB	TC	Ruby	1.0g	2.0	1.0	14.0	5.0
2.0-17-5 NTB	TC	Ruby	1.0g	2.0	1.0	17.0	8.0
2.0-20-5 NTB	TC	Ruby	1.0g	2.0	1.0	20.0	11.0
2.0-25-5 NTB	TC	Ruby	1.1g	2.0	1.0	25.0	16.0
2.0-30-5 NTB	TC	Ruby	1.1g	2.0	1.0	30.0	21.0
2.0-35-5 NTB	TC	Ruby	1.6g	2.0	1.5	35.0	26.0
2.0-40-5 NTB	TC	Ruby	1.8g	2.0	1.5	40.0	31.0
2.5-20-5 NTB	TC	Ruby	1.3g	2.5	1.5	20.0	11.0
2.5-25-5 NTB	TC	Ruby	1.4g	2.5	1.5	25.0	16.0
2.5-30-5 NTB	TC	Ruby	1.5g	2.5	1.5	30.0	21.0
2.5-35-5 NTB	TC	Ruby	1.6g	2.5	1.5	35.0	26.0
2.5-40-5 NTB	TC	Ruby	1.8g	2.5	1.5	40.0	31.0

TC = Tungsten Carbide

M3 (Ø 5 mm)

M3 Thread Styli (Body Ø5mm)

Styli (Type CA) Carbon Fiber

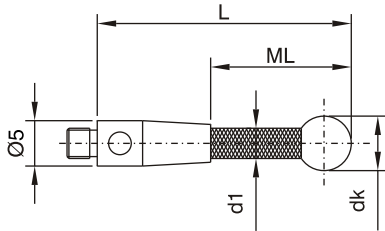

Order No.	Shaft	Ball	wt	dk mm	d1 mm	L mm	ML mm
3.0-25-5 NTCA	CF	Ruby	0.6g	3.0	2.0	25.0	16.0
3.0-33-5 NTCA	CF	Ruby	0.7g	3.0	2.0	33.0	24.0
3.0-40-5 NTCA	CF	Ruby	0.8g	3.0	2.0	40.0	31.0
3.0-42-5 NTCA	CF	Ruby	0.8g	3.0	2.0	42.0	33.0
3.0-50-5 NTCA	CF	Ruby	0.8g	3.0	2.0	50.0	41.0
3.0-58-5 NTCA	CF	Ruby	1.0g	3.0	2.0	58.0	49.0
3.0-59-5 NTCA	CF	Ruby	1.0g	3.0	2.0	59.0	50.0
3.0-65-5 NTCA	CF	Ruby	1.0g	3.0	2.0	65.0	56.0
3.0-75-5 NTCA	CF	Ruby	1.0g	3.0	2.0	75.0	66.0
3.0-84-5 NTCA	CF	Ruby	1.1g	3.0	2.0	84.0	75.0
3.0-100-5 NTCA	CF	Ruby	1.1g	3.0	2.0	100.0	91.0
3.0-125-5 NTCA	CF	Ruby	1.2g	3.0	2.0	125.0	116.0
4.0-50-5 NTCA	CF	Ruby	1.0g	4.0	2.0	50.0	41.0
5.0-30-5 NTCA	CF	Ruby	1.1g	5.0	3.0	30.0	21.0
5.0-40-5 NTCA	CF	Ruby	1.2g	5.0	3.0	40.0	31.0
5.0-50-5 NTCA	CF	Ruby	1.4g	5.0	3.0	50.0	41.0
5.0-60-5 NTCA	CF	Ruby	1.5g	5.0	3.0	60.0	51.0
5.0-75-5 NTCA	CF	Ruby	1.8g	5.0	3.0	75.0	66.0
6.0-50-5 NTCA	CF	Ruby	1.5g	6.0	3.0	50.0	41.0
6.0-70-5 NTCA	CF	Ruby	1.8g	6.0	3.0	70.0	61.0
6.0-100-5 NTCA	CF	Ruby	2.4g	6.0	3.0	100.0	91.0
8.0-30-5 NTCA	CF	Ruby	1.8g	8.0	5.0	30.0	30.0
8.0-50-5 NTCA	CF	Ruby	2.1g	8.0	5.0	50.0	50.0
8.0-70-5 NTCA	CF	Ruby	2.6g	8.0	5.0	70.0	70.0
8.0-100-5 NTCA	CF	Ruby	2.7g	8.0	5.0	100.0	100.0
8.0-125-5 NTCA	CF	Ruby	2.9g	8.0	5.0	125.0	125.0

Extensions, Light-weight Carbon Fiber

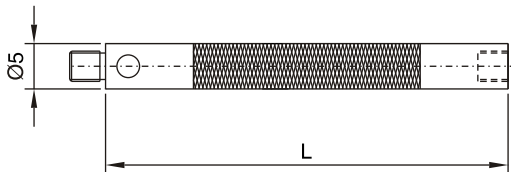

Order No.	Material	wt	L mm
20-5 NVCA	CF	1.7g	20.0
25-5 NVCA	CF	1.8g	25.0
30-5 NVCA	CF	1.9g	30.0
40-5 NVCA	CF	2.1g	40.0
50-5 NVCA	CF	2.2g	50.0
60-5 NVCA	CF	2.4g	60.0
65-5 NVCA	CF	2.5g	65.0
75-5 NVCA	CF	2.6g	75.0
80-5 NVCA	CF	2.7g	80.0
100-5 NVCA	CF	3.0g	100.0
130-5 NVCA	CF	3.5g	130.0
150-5 NVCA	CF	3.8g	150.0

CF = Carbon Fiber