

Styli for UMM / ULM / Metroscope

Order No.	Size	Ball	dk mm	MD mm
0.200 NTTG	0-200	Tungsten Carbide	0.200	1.0
0.250 NTTG	0-250	Tungsten Carbide	0.250	1.8
0.280 NTTG	0-280	Tungsten Carbide	0.280	1.8
0.290 NTTG	0-290	Tungsten Carbide	0.290	1.8
0.300 NTTG	0-300	Tungsten Carbide	0.300	1.8
0.335-0 NTTG	0	Tungsten Carbide	0.335	2.0
0.455-1 NTTG	1	Ruby	0.455	2.5
0.530-2 NTTG	2	Ruby	0.530	3.3
0.620-3 NTTG	3	Ruby	0.620	4.0
0.725-4 NTTG	4	Ruby	0.725	5.0
0.895-5 NTTG	5	Ruby	0.895	6.0
1.100-6 NTTG	6	Ruby	1.100	8.0
1.350-7 NTTG	7	Ruby	1.350	9.0
1.650-8 NTTG	8	Ruby	1.650	12.0
2.050-9 NTTG	9	Ruby	2.050	13.0
2.550-10 NTTG	10	Ruby	2.550	16.0
3.200-11 NTTG	11	Ruby	3.200	20.0
4.000-12 NTTG	12	Ruby	4.000	25.0

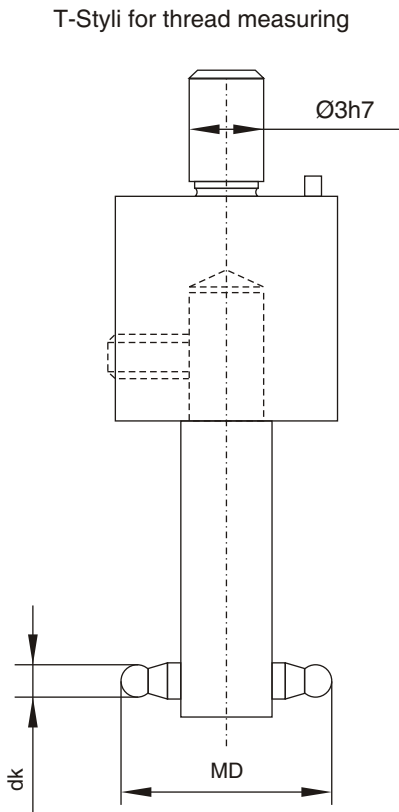

Original Equipment for TRIMOS / MAHR

T-Styli with Ruby balls to measure the flank diameter of female thread.

Note:- Please specify the required position of Ruby balls, i.e. 90° or parallel to locking pin.

Order No.	Content	Size
12 NTBG	12 Parts	1 TO 12
13 NTBG	13 Parts	0 TO 12
14 NTBG	14 Parts	0-300 TO 12

T-Styli set (complete set) with wooden case